

Super Playground.

SUPERSTUDIO **VILLAGE**
BOVISA

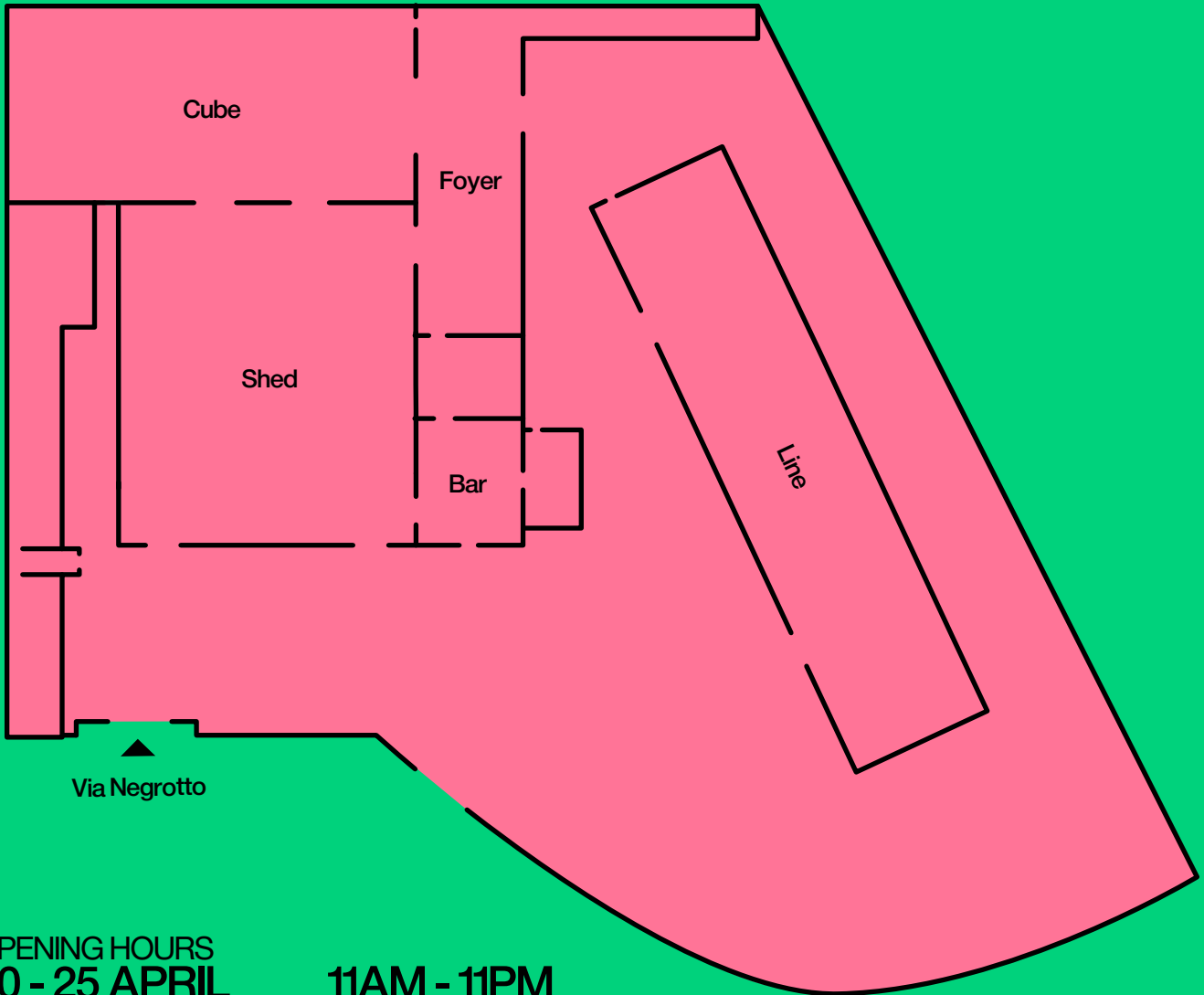

OPENING HOURS
20 - 25 APRIL
26 APRIL

11AM - 11PM
11AM - 6PM

VENUE ADDRESS
VIA NEGROTTA 59 - 20157, MILAN

HOW TO REACH US

METRO: yellow line M3, Affori FN stop + Bus line 35

BUS: lines 35 – 82 – 92

TRAM: line 2

TAXI STATION: Milano Bovisa FN / Bovisa-Politecnico

CYCLE PATHS: located in Viale Fermi and Parco Nord Milano area

PARKING: Milano Nord Bovisa parking

LINATE AIRPORT: blue line M4, Dateo stop + Trenord lines S5/S6, Villapizzone stop

MALPENSA AIRPORT: Malpensa Express train towards Centrale, Milano Bovisa-Politecnico stop

Super Nova.

SUPERSTUDIO PIÙ
TORTONA



OPENING HOURS
20 - 25 APRIL
26 APRIL

11AM - 9PM
11AM - 6PM

VENUE ADDRESS
VIA TORTONA 27 – 20144, MILAN

HOW TO REACH US

METRO: Green Line M2, Porta Genova or Sant'Agostino stop

BUS: lines 68 – 74 – 90/91

TRAM: lines 2 – 9 – 10 – 14

TAXI STATION: near Superstudio Più, Piazza delle Culture

CYCLE PATHS: located in Via Tortona, Navigli, Porta Genova and Solari area

PARKING: MUDEC museum parking nearby

LINATE AIRPORT: blue line M4, California stop

MALPENSA AIRPORT: Malpensa Express train + Green Line M2, Porta Genova or Sant'Agostino stop

Super City.

SUPERSTUDIO **MAXI**
BARONA

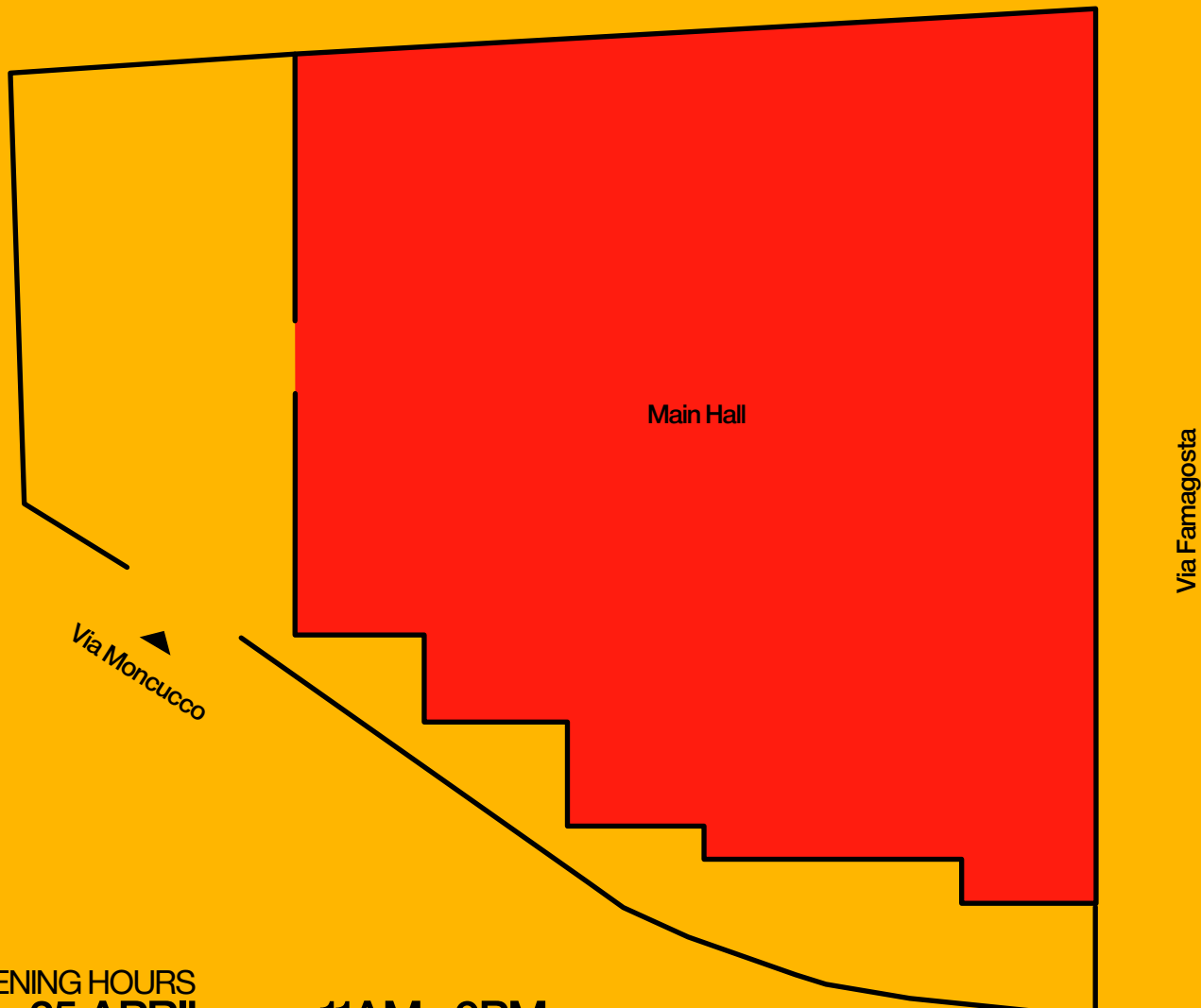

OPENING HOURS
20 - 25 APRIL
26 APRIL

11AM - 9PM
11AM - 6PM

VENUE ADDRESS
VIA MONCUCCO 35 – 20142, MILAN

HOW TO REACH US

METRO: Green Line M2, Famagosta stop

BUS: lines 46 – 59 – 71 – 74 – 98

TRAM: line 3, Via Montegani – V.Le Da Cermenate stop

TAXI STATION: near Famagosta M2 Station

CYCLE PATHS: located in Viale Cassala, Naviglio Pavese, Parco Agricolo Sud Milano, and the Gratosoglio area

PARKING: ATM Famagosta Parking

LINATE AIRPORT: blue line M4, Sant'Ambrogio stop + Green Line M2, Famagosta stop

MALPENSA AIRPORT: Malpensa Express train + Green Line M2, Famagosta stop